

Content

Screws 30mm
(the number varies depending on the size of the side)

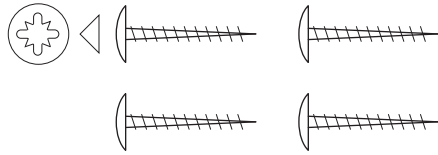

1. Put the side in place.

Be aware that the side is approximately 17mm deeper than the cabinet in order to cover the edge of the front. The side's back edge should align with the cabinet's back so that the side's front edge is 17mm further out than the cabinet's front edge.

2. Screw the side.

Place the screws as shown in the drawing: one in every outer hole up and down and the rest spread in between. Use 8 screws for sides higher than 200cm and 6 for sides higher than 80cm. For sides lower than 80cm, it is enough with 4 screws.

IMPORTANT: Do not drive the screw deeper into the cabinet side, than that the head of the screw aligns with the surface of the cabinet side. See below.

DON'T LET THE SCREW'S HEAD CONTINUE INTO THE CABINET SIDE

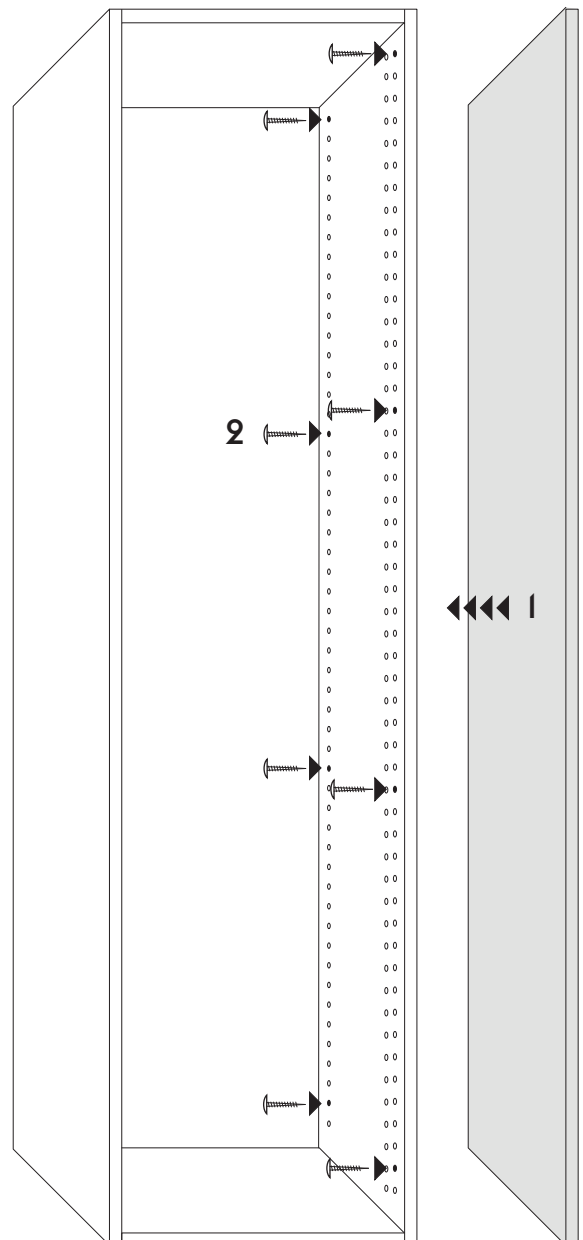
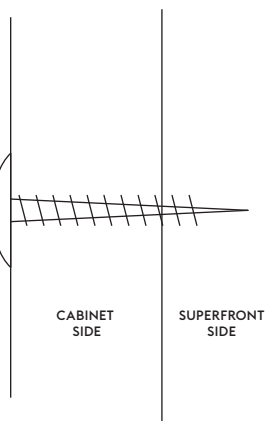

Safety!

Be sure to always follow the safety instructions that apply to your furniture. Always secure the cabinet to the wall. This also applies to low cabinets where the weight distribution changes drastically when the fronts open. Especially in the case of solid quality fronts as ours. Use the anchor brackets supplied with the Ikea cabinet.