

Content

4 x Screws per shelf



4 x MountPads per shelf



2 x Slats

1-3 Shelves (depending on model)



2 x Blocks per shelf



IMPORTANT!

Screws for mounting the shelf to the wall are not included. Examine your wall to determine what type of screws and plugs you need to buy and where you can drill. The diameter of the screw must not exceed 6 mm.

1.

Attach the blocks to the slats using the screws provided. It is important that this is done by hand with a screwdriver – not by machine. And don't use all your strength as the screw is self-tapping.

2.

Measure where on the wall you need to drill to get the shelf where you want it. Keep in mind that the brackets should be mounted at a distance from the edge of the shelf. We recommend at least 10 cm.

3.

Drill, plug and finally screw the brackets in place. The longer end of the slat should be upwards.

TIP!

A spirit level or equivalent will help you get the shelf straight.

SIDE VIEW

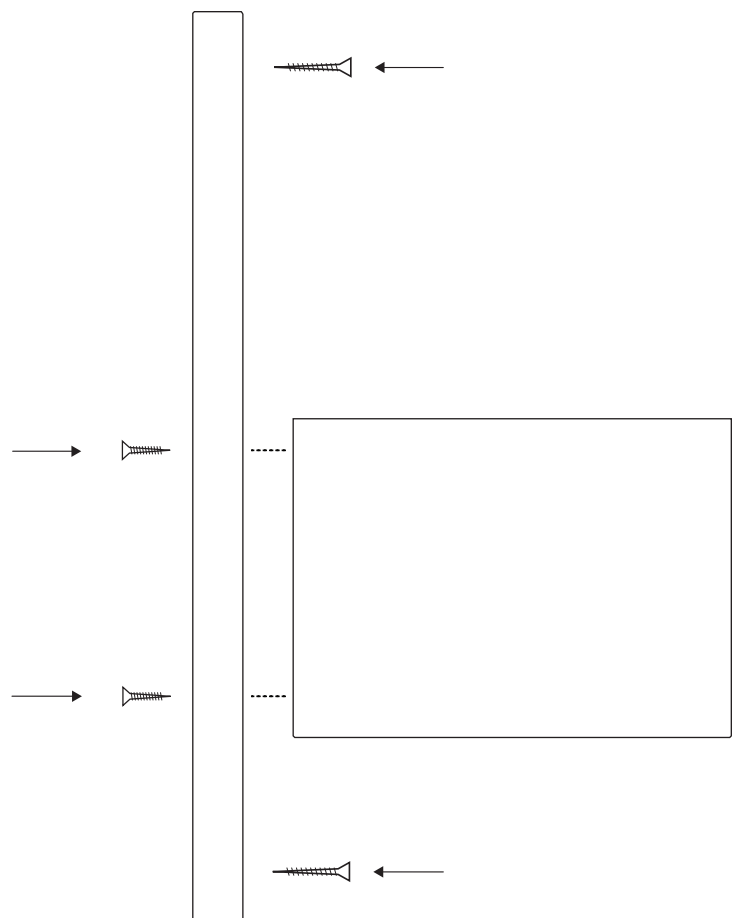

4.

Stick the supplied MoundPads to the top of the blocks. Leave the protective plastic on so you can practice once to put the shelf in the right place.

5.

Remove the plastic, put the shelf in place and press lightly to secure its position. All done!

SIDE VIEW

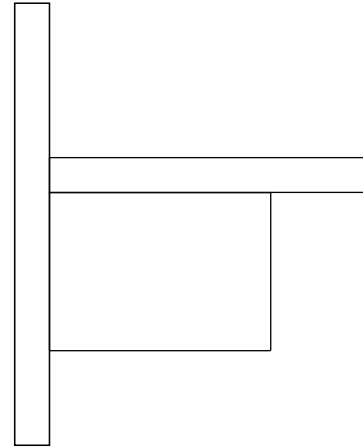

FRONTVIEW

