

### Content

1 x SuperMountPlate

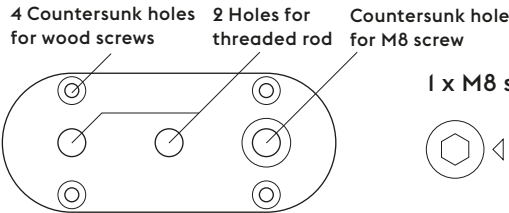

1 x M8 screw

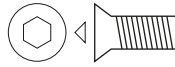

1 x Threaded rod

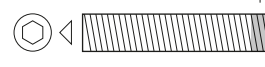

LOCTITE

4 x Wood screw

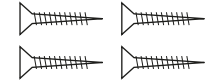

### Bestå frame

**1.** Attach the SuperMountPlate with the M8 screw in the existing screw hole located in all 4 corners at the bottom of the Ikea frame. Rotate the SuperMountPlate to get the leg where you want it.

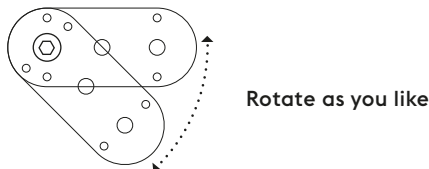

**2.** Screw the wood screws into the countersunk holes to lock the SuperMountPlate in the correct position.

**3.** Then screw the threaded rod into one of the holes depending on where you want the leg placed. Be sure that the threaded rod goes in the right way - the end that is dipped in Loctite should go in the SuperMountPlate.

**4.** Finally, screw the leg onto the threaded rod.

### Mounting in the joint between 2 Bestå frames.

**1.** Attach the SuperMountPlate with the M8 screw in the existing screw hole in one of the frames.

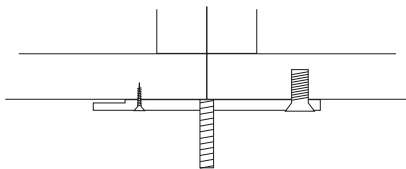

**2.** Screw the wood screws into both frames to lock the SuperMountPlate in the correct position.

**3.** Screw on the threaded rod and then the leg. Done!

### Metod frame

**1.** Here it's very important that the SuperMountPlate is mounted so that the cabinet side rests on the SuperMountPlate.

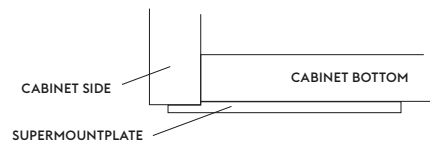

**2.** Attach the SuperMountPlate with the 4 wood screws.

**3.** Screw on the threaded rod and then the leg. Be sure that the threaded rod goes in the right way - the end that is dipped in Loctite should go in the SuperMountPlate.

### Mounting in the joint between 2 Metod frames.

**1.** For the SuperMountPlate to end up tight against the frame, you can cut off some of the side piece that protrudes below the bottom piece (where the SuperMountPlate should be). You can use a breaker blade for this task!

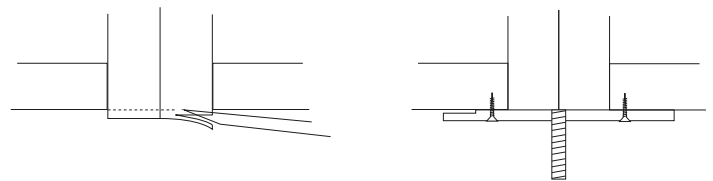

**2.** Place the SuperMountPlate centered between the frames.

**3.** Screw the wood screws into the countersunk holes.

**4.** Screw on the threaded rod and then the leg. Done!

**NOTE!** Be careful when you turn the furniture over.

### Safety!

Be sure to always follow the safety instructions that apply to your furniture. Always secure the cabinet to the wall. This also applies to low cabinets where the weight distribution changes drastically when the fronts open. Especially in the case of solid quality fronts as ours. Use the anchor brackets that come with the Ikea cabinet.

### Mounting

There are two different options for mounting legs on your sofa / bed. Which option you should choose depends on what the bottom of your sofa / bed looks like. See the different options to the right.

### Number of legs

Follow the instructions from the manufacturer regarding how many legs you need for your sofa / bed.

### Important!

To make sure not to stress the legs sideways when you turn the couch / bed around, it is important that you lift, and not just tilt it over.

### Mounting in existing M8 screw hole

If your sofa / bed has an existing screw hole in the bottom, you can mount the leg as described below. These holes exist in the Ikea sofas Landskrona, Söderhamn and Norsborg.

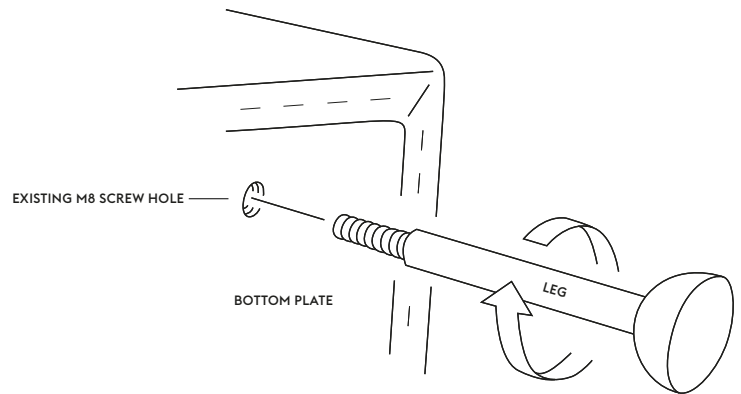

### Mounting with SuperMountPlate (lack of M8 hole)

If your sofa / bed has no existing holes in the bottom, you can mount the leg as described below. This requires that your sofa / bed has a screw-friendly bottom plate / wooden frame.

**Tip!** Pre-drill the holes for the screws with a thin drill bit (maximum 2.5mm) before screwing for the screw to get a better fastening and to avoid cracking the wood. It is important that you ensure that the screws are long enough and that they are properly fastened. In some cases, you may need to replace the supplied screws with longer screws.

